



Brent

Licence Number: 11955

Adult Gaming Centre Premises Licence

This licence is issued under section 164 of the Gambling Act 2005 by

LONDON BOROUGH OF BRENT

Part 1 – Details of person to whom licence is issued

This premises licence is issued to:

Future Leisure Limited

of the following address:

**Unit 20 Fleetway Business Park, 14-16 Wadsworth Road, Greenford,
Middlesex, UB6 7LD**

who holds an operating licence which has been given the following operating number by the Gambling Commission: **000-036646-N-318600-006**

Part 2 – Details of the premises in respect of which the licence is issued

Facilities for gambling may be provided in accordance with this licence on the following premises:

9A Walm Lane, London, NW2 5SJ

Part 3 – Premises Licence details

This licence came into effect on: **4 July 2018**

This licence is of unlimited duration.

The following conditions have been attached to the licence by the issuing authority under section 169(1)(a) of the Gambling Act 2005:

ANNEX A - CONDITIONS TO BE ATTACHED

Condition to be attached	Reasons for attaching condition
<p>A comprehensive CCTV system shall be installed and maintained on the premises as required by the Metropolitan Police Licensing Team. CCTV should cover the following:</p> <ul style="list-style-type: none"> a) All entry and exit points to and from the premises enabling frontal identification of every person entering under any light conditions; b) The areas of the premises to which the public have access (excluding toilets); and c) Gaming machines and the counter area. 	<p>This condition was agreed with the Licensing Authority and imposed by the sub-committee.</p>
<p>The CCTV shall continue to record activities 24 hours a day and shall be kept for 31 days.</p>	<p>This condition was agreed with the Licensing Authority and imposed by the sub-committee.</p>
<p>The premises shall display notices near the entrance of the venue stating that CCTV is in operation.</p>	<p>This condition was agreed with the Licensing Authority and imposed by the sub-committee.</p>
<p>CCTV shall be made available for the police and licensing authority viewing at any time with minimum delays when requested.</p>	<p>This condition was agreed with the Licensing Authority and imposed by the sub-committee.</p>
<p>A monitor shall be placed inside the premises above the front door showing CCTV images of customers entering exiting the premises.</p>	<p>This condition was agreed with the Licensing Authority and imposed by the sub-committee.</p>
<p>The Licensee shall maintain a bound and paginated 'Challenge 25 Refusals' register at the premises. The register shall be produced to the police or licensing authority forthwith on request.</p>	<p>This condition was agreed with the Licensing Authority and imposed by the sub-committee.</p>
<p>Prominent signage and notices advertising the Challenge 25 will be displayed showing the operation of such policy.</p>	<p>This condition was agreed with the Licensing Authority and imposed by the sub-committee.</p>
<p>Third party testing on age restricted sales systems purchasing shall take place at least twice a year and the results shall be provided to the Licensing Authority upon request.</p>	<p>This condition was agreed with the Licensing Authority and imposed by the sub-committee.</p>
<p>A Challenge 25 proof of age scheme shall be operated at the premises where the only acceptable forms of identification are recognised photographic identification cards, such as a driving licence, passport or proof of age card with the PASS Hologram.</p>	<p>This condition was agreed with the Licensing Authority and imposed by the sub-committee.</p>

The Licensee shall implement a policy of banning any customers who engage in crime or disorder within or outside the premises.	This condition was agreed with the Licensing Authority and imposed by the sub-committee.
The licensee will refuse entry to customers who appear to be under the influence of alcohol or drugs.	This condition was agreed with the Licensing Authority and imposed by the sub-committee.
The licensee shall ensure that all seating within the premises are either secured to the floor or are weighted to prevent lifting.	This condition was agreed with the Licensing Authority and imposed by the sub-committee.
The licensee shall install and maintain an intruder alarm on the premises.	This condition was agreed with the Licensing Authority and imposed by the sub-committee.
The premises shall install and maintain a panic button conveniently available to staff.	This condition was agreed with the Licensing Authority and imposed by the sub-committee.
There shall be a locking device on the front door at all times.	This condition was agreed with the Licensing Authority and imposed by the sub-committee.
All doors and windows shall remain closed during any licensable activity save when people are entering or exiting.	This condition was agreed with the Licensing Authority and imposed by the sub-committee.
The licensee will ensure that customer toilets are checked every hour for evidence of drug taking. Toilet checks are to be documents stating the time and member of staff who made the checks.	This condition was agreed with the Licensing Authority and imposed by the sub-committee.
Toilet doors shall be kept locked and access given by staff only.	This condition was agreed with the Licensing Authority and imposed by the sub-committee.
Prominent GamCare documentation will be displayed at the premises.	This condition was agreed with the Licensing Authority and imposed by the sub-committee.
The licensee shall: provide training on the specific local risks to the licensing objectives that have been identified for these premises as part of the staff induction training programme. periodically provide refresher training to all of its staff working at these premises on the specific local risks to the licensing objectives. Participation in this training shall be formally recorded on each member of staffs training records which, if requested will be presented to the Licensing Authority as soon as practicable.	This condition was agreed with the Licensing Authority and imposed by the sub-committee.

<p>The Licensee shall train staff on specific issues related to the local area and shall conduct periodic refresher training. Participation in this training shall be formally recorded and the records produced to the police or licensing authority upon request.</p>	<p>This condition was agreed with the Licensing Authority and imposed by the sub-committee.</p>
<p>New and seasonal staff must attend induction training and receive refresher training every six months. Participation in this training shall be formally recorded and the records produced to the police or licensing authority upon request.</p>	<p>This condition was agreed with the Licensing Authority and imposed by the sub-committee.</p>
<p>The Licensee shall take all reasonable steps to prevent street drinking of alcohol directly outside the premises and to ban from the premises those who do so.</p>	<p>This condition was agreed with the Licensing Authority and imposed by the sub-committee.</p>
<p>The Licensee shall place a notice visible from the exterior of the premises stating that customers drinking alcohol outside the premises is not permitted and those who do so will be banned from the premises.</p>	<p>This condition was agreed with the Licensing Authority and imposed by the sub-committee.</p>
<p>An incident log shall be kept for the premises and made available on request to an authorised officer of the City Council or the Police which will record the following;</p> <ul style="list-style-type: none"> a) All crimes reported to the venue; b) Any complaints received regarding crime and disorder; c) Any incidents of disorder; d) Any faults in the CCTV system; and e) Any visit by a relevant authority or emergency service. f) Refusals, banned and self-excluded customers. 	<p>This condition was agreed with the Licensing Authority and imposed by the sub-committee.</p>
<p>A fire alarm and smoke detection system will be installed.</p>	<p>This condition was agreed with the Licensing Authority and imposed by the sub-committee.</p>
<p>There will be a minimum of 2 staff members present at all times when the premises are open.</p>	<p>This condition was imposed by the sub-committee as being a necessary and proportionate measure.</p>

<p>A clear and unobstructed view into the premises is to be maintained. This is to be achieved by having clear, non-tinted glass in the entrance door and front windows, no signage or visual obstructions on the entrance door, and one of the two window displays as shown on the plans submitted and approved with the application.</p>	<p>This condition was imposed by the sub-committee as being a necessary and proportionate measure.</p>
--	---

ANNEX B - EXCLUDED CONDITIONS

The following conditions, which would otherwise attach to the licence by virtue of regulations made under section 168 of the Gambling Act 2005, have been excluded by the issuing authority under section 169(1)(b) of that Act:

N/A

ANNEX C - REPRESENTATION

Representation	Licensing authority's response
Metropolitan Police	Valid
Licensing	Valid

A scale plan is attached as an annex to this licence

Signed on behalf of the issuing licensing authority

Signed..... *AKtar. Choudhary*
 Operational Director, Planning & Regeneration

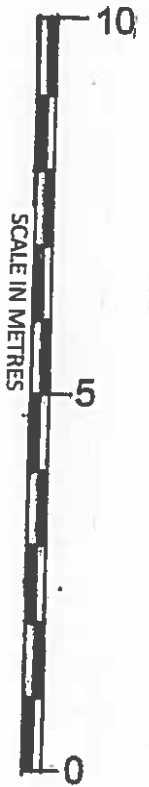
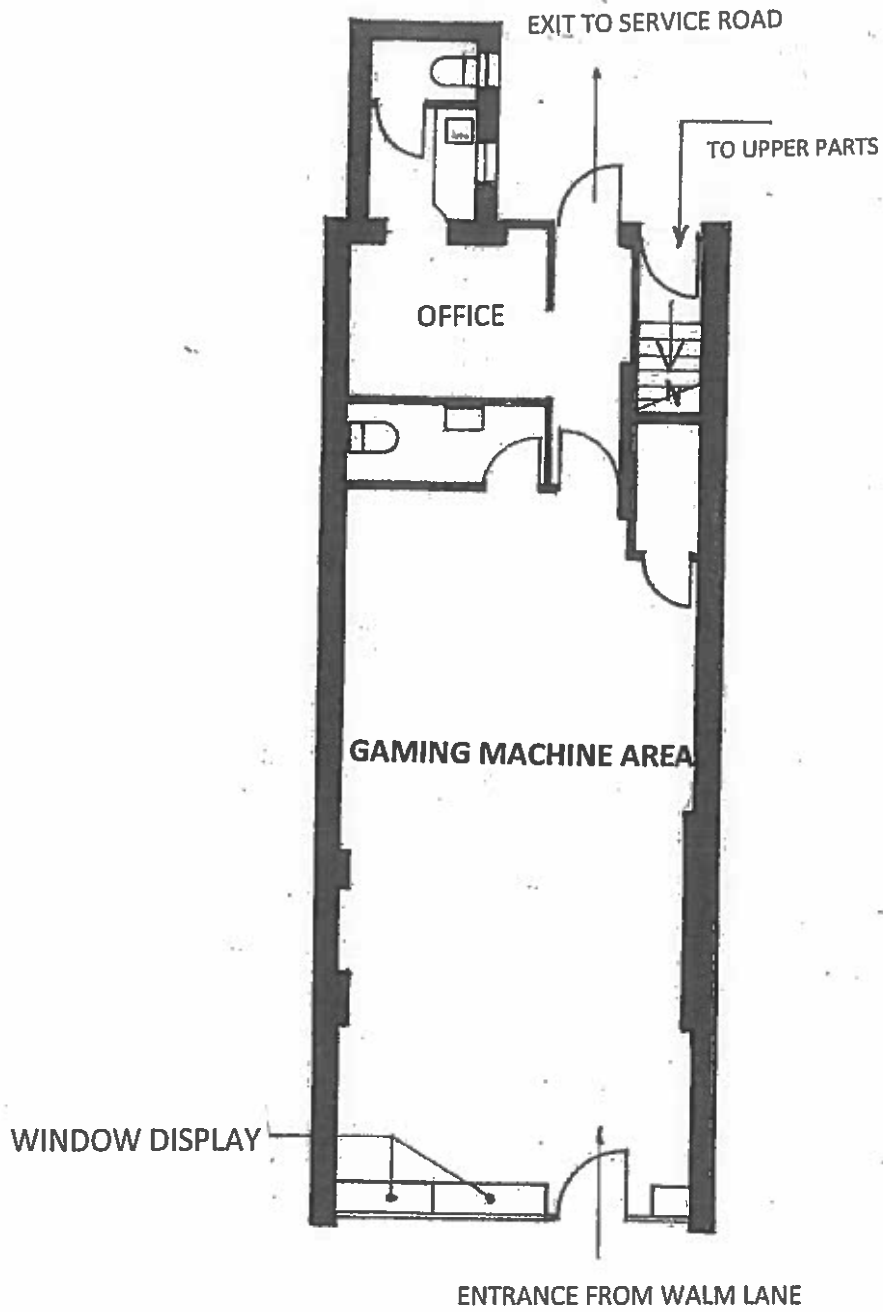

9A WALM LANE, LONDON, NW2 5SJ - LICENCE PLAN - SCALE 1:100

